

MACHINE SCREW

ACTUATORS

75 TON CAPACITY

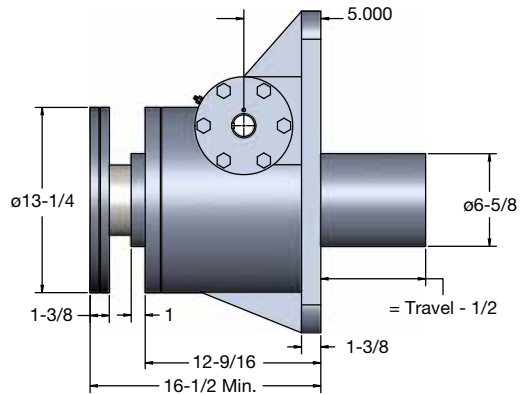
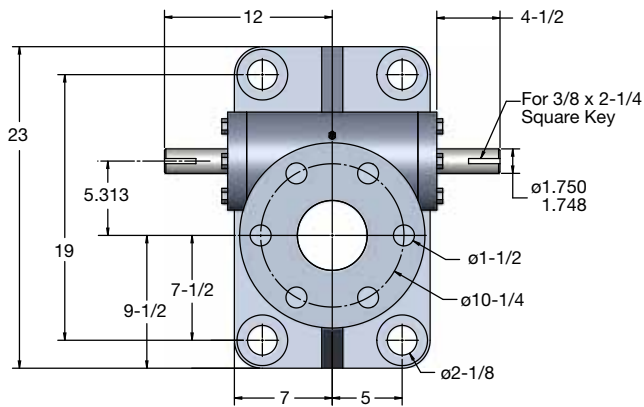

Upright: M-9075

5" Diameter x .666 Lead Lifting Screws

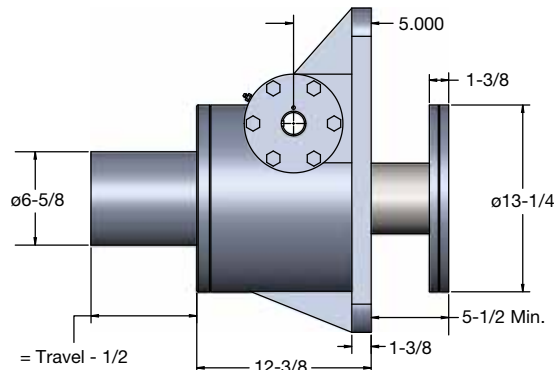
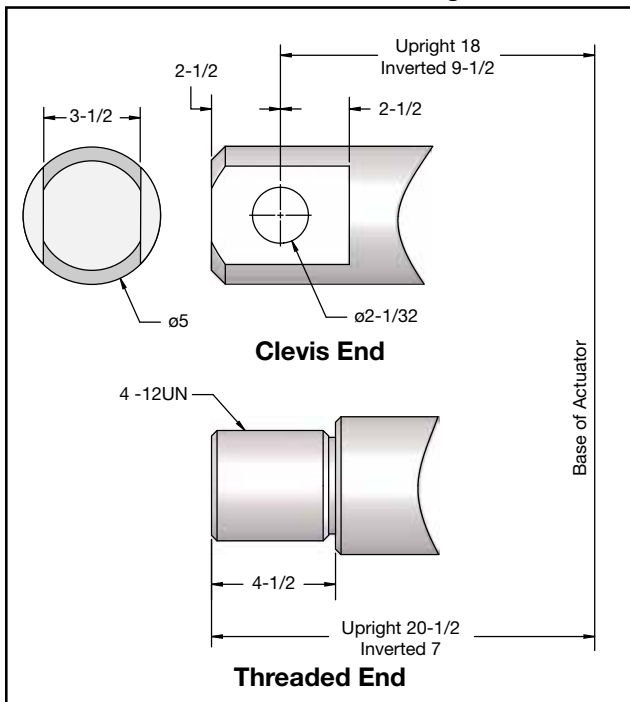

Inverted: M-9074

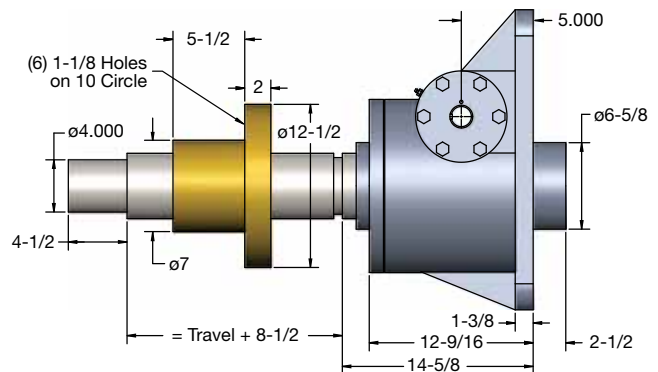

Upright Rotating: UM-9076

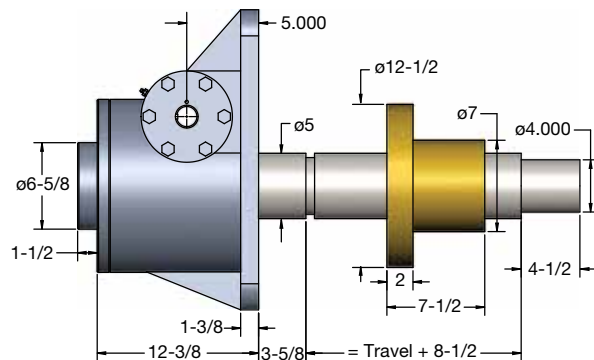

Inverted Rotating: DM-9076

Note: Lifting screw is not keyed. Top should be secured to a lifting member to prevent rotation. When a Bellows Boot is required, see pages 148-149. Dimensions are subject to change without notice.