

SCREW JACK

POWER TRANSMISSION COMPONENTS

ACTUATOR FLANGE BLOCKS

Duff-Norton provides a wide assortment of Flange Blocks designed to operate with our rotating type Machine Screw, Ball Screw, and Continuous Duty actuators. Flange Blocks lock on to the end of the rotating screw, and can then be bolted on to the machine or fixture. This ensures that the load being carried by the actuator's lifting nut is properly guided.

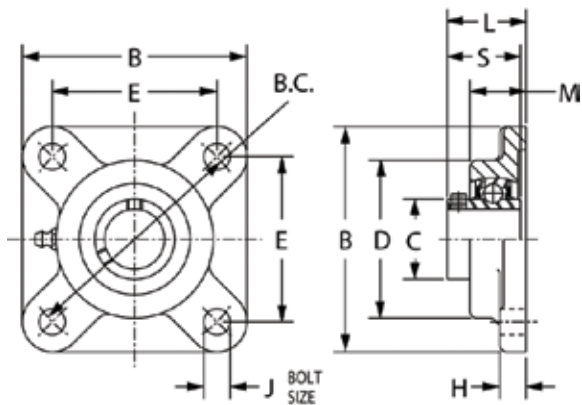

Flange Block

Rotating Screw Actuator



FEATURES

- Ductile iron housing - for extra strength vs. the standard gray iron.
- Setscrew locks - to properly secure the connecting shaft regardless of direction.
- Anti-rotation Pins - to help prevent random bearing movement.

For more Pillow Block information please see the table below

Part Number	Rotating Actuator	Shaft Size	B	B.C.	C	D	E	H	J	L	M	S	Weight (lbs)
FB50C	MS and BS up to 1 Ton	1/2	3	3	.969	2-3/32	2-1/8	7/16	3/8	1-7/32	31/32	1.079	1.0
FB63C	2 Ton MS	5/8	3	3	.969	2-3/32	2-1/8	7/16	3/8	1-7/32	31/32	1.079	1.0
FB75C	2 and 3 Ton BS	3/4	3-3/8	3-5/8	1.142	2-3/8	2-1/2	19/32	3/8	1-15/32	1-5/32	1.220	1.5
FB87C	3 Ton MS	7/8	3-21/32	3-57/64	1.339	2-3/4	2-3/4	19/32	7/16	1-17/32	1-3/16	1.399	1.9
FB100C	5 Ton MS, 5-10 Ton BS	1	3-21/32	3-57/64	1.339	2-3/4	2-3/4	19/32	7/16	1-17/32	1-3/16	1.399	1.9
FB125C	10 Ton MS	1-1/4	4-9/16	5-1/8	1.843	3-9/16	3-5/8	11/16	1/2	1-27/32	1-3/8	1.689	4.4
FB150C	15 Ton MS	1-1/2	5-3/32	5-43/64	2.063	4-1/32	4	11/16	1/2	2-1/8	1-17/32	1.937	5.6
FB175C	20 Ton MS and BS	1-3/4	5-5/16	5-27/32	2.260	4-1/4	4-1/8	23/32	1/2	2-1/8	1-9/16	1.937	6.0
FB225C*	25 Ton BS	2-1/4	6-29/32	7-31/32	2.949	5-5/16	5-5/8	23/32	5/8	2-43/64	1-57/64	2.114	11.9

*Cast iron housing