

Actuator Flange Blocks

NEW

Duff-Norton provides a wide assortment of Flange Blocks designed to operate with our rotating type Machine Screw, Ball Screw, and Continuous Duty actuators. Flange Blocks lock on to the end of the rotating screw, and can then be bolted on to the machine or fixture. This ensures that the load being carried by the actuator's lifting nut is properly guided.



Features

- Ductile iron housing - for extra strength vs. the standard gray iron
- Setscrew locks – to properly secure the connecting shaft regardless of direction.
- Anti-Rotation Pins – to help prevent random bearing movement.

For more Flange Block information please see the tables below.

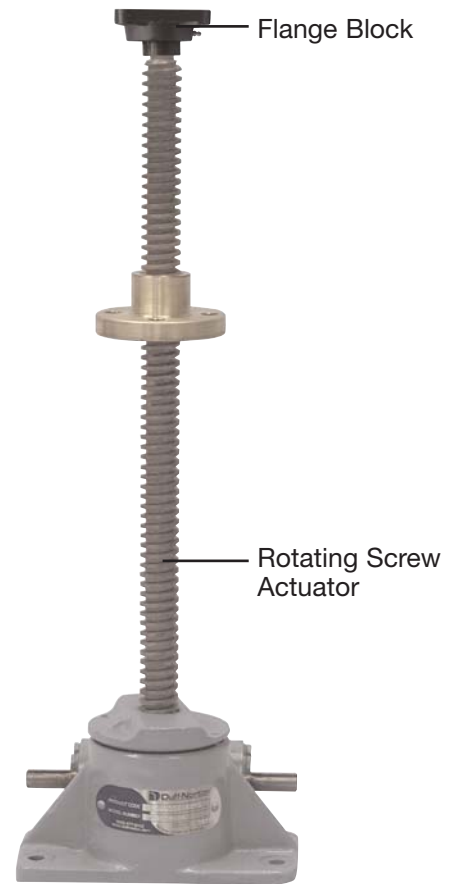
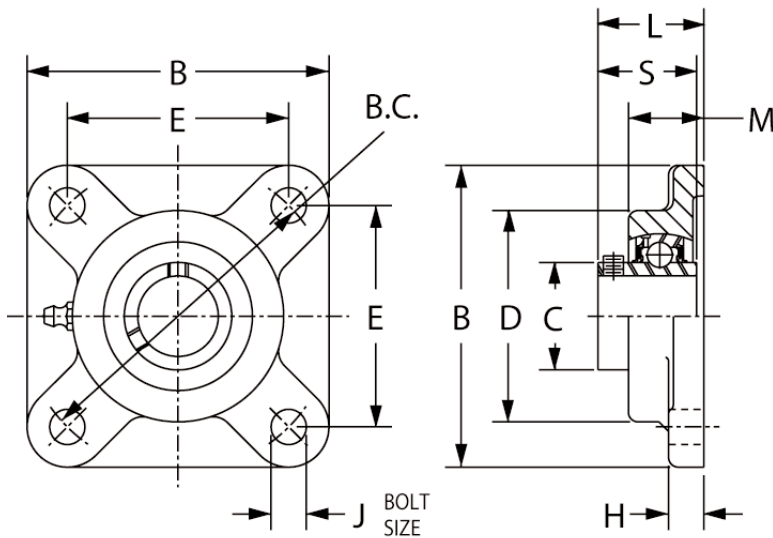

Flange Block Dimensional Specifications

Part #	Rotating Actuator	Shaft Size	B	B.C.	C	D	E	H	J	L	M	S	Wt.Lbs.
FB50	MS and BS up to 1 Ton	1/2	3	3	.969	2 3/32	2 1/8	7/16	3/8	1 7/32	31/32	1.079	1.0
FB63	2 Ton MS	5/8	3	3	.969	2 3/32	2 1/8	7/16	3/8	1 7/32	31/32	1.079	1.0
FB75	2 and 3 Ton BS	3/4	3 3/8	3 5/8	1.142	2 3/8	2 1/2	19/32	3/8	1 15/32	1 5/32	1.220	1.5
FB87	3 Ton MS	7/8	3 21/32	3 57/64	1.339	2 3/4	2 3/4	19/32	7/16	1 17/32	1 3/16	1.399	1.9
FB100	5 Ton MS, 5-10Ton BS	1	3 21/32	3 57/64	1.339	2 3/4	2 3/4	19/32	7/16	1 17/32	1 3/16	1.399	1.9
FB124	10 Ton MS	1 1/4	4 9/16	5 1/8	1.843	3 9/16	3 5/8	11/16	1/2	1 27/32	1 3/8	1.689	4.4
FB150	15 Ton MS	1 1/2	5 3/32	5 43/64	2.063	4 1/32	4	11/16	1/2	2 1/8	1 17/32	1.937	5.6
FB175	20 Ton MS & BS	1 3/4	5 5/16	5 27/32	2.260	4 1/4	4 1/8	23/32	1/2	2 1/8	1 9/16	1.937	6.0
FB225*	25 Ton BS	2 1/4	6 29/32	7 31/32	2.949	5 5/16	5 5/8	23/32	5/8	2 43/64	1 57/64	2.114	11.9

Cast iron housing